

PIR FLUSHING CONTROLS FOR URINAL CISTERNS ECO EU9 AND EU10

eco-logic uk

Controlling urinal flush cycles is a highly cost effective way to prevent excessive water wastage, whilst maintaining hygiene requirements. ECO-Logic Urinal Controllers deliver high quality and cost efficient installations that fully comply with water regulations. They are simple to install and setup. Payback times on average are within 6 months*.

* Over unregulated systems.



Range

ECO EU9	Surface Mounted PIR Flush Controller
ECO EU10	Concealed PIR Flush Controller for installation behind ceiling tiles or panels.
ECO EU9M / EU10M	As above, but modified for mains power*
ECO EU9-SB	Metal security box cover for EU9 Controller

*For full details of ECO-Logic Transformers see TPS TR15

Features

- Robust with low maintenance requirements
- Duty Flush automatically activates if not used within 12 or 24 hours
- Time saving, simple 'One Touch' setup
- Two year guarantee on all electronic components
- Long life lithium battery power or reduced mains power options
- Extra safe 6vDC power

Benefits

- Excellent payback and ongoing water savings
- Proven water and water cost savings of approx 75%*
- Fully automatic hygienic control
- Safe operation
- Low maintenance
- Secure metal cover available
- Fully meets water regulations

*Over uncontrolled systems

Function

The controller contains a Passive Infra Red Sensor (PIR) which automatically activates when it detects body heat movement. The PIR can scan a range up to 4 metres high and 2-3 metres wide. When triggered it starts a timing sequence to release water to fill the cistern, which then flushes the urinals. The Controller then awaits the next activation. The timings are fully adjustable to suit each installation.

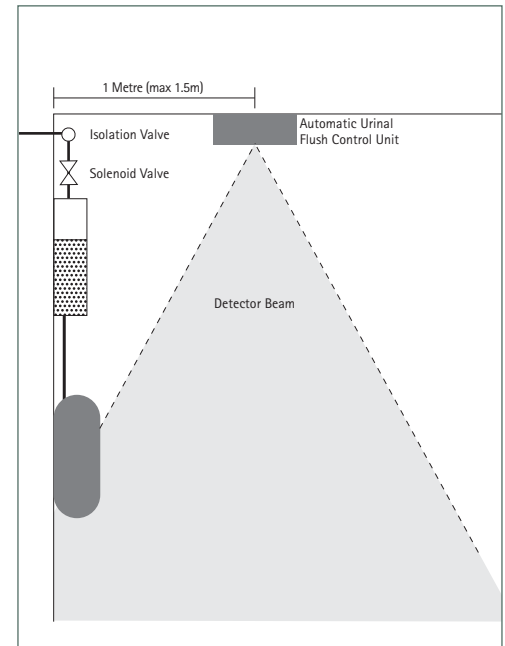

The correct positioning of the PIR sensors depends on assessing the main direction of movement of people under the sensor. These sketches illustrate the principal that the traffic flow should pass through the sensor detection beam.

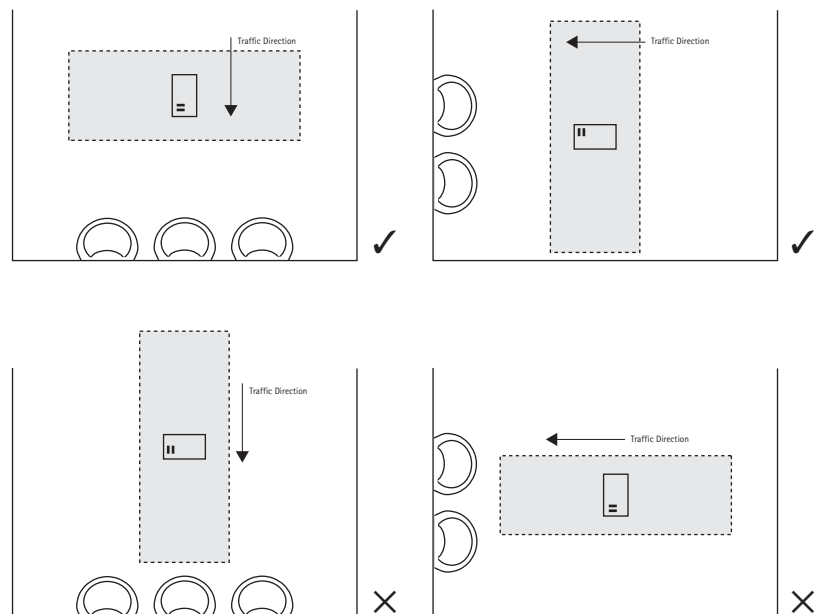

ECO-Logic Controller & Components

PIR Sensor and Controller

- Controller enables timing variations for cistern fill and delays before reactivation
- Sensor has range variation
- Duty Flush options

Solenoid Valve

- Opens/closes to the Controllers commands

Battery Pack*

- Supplied with connector pins and link cable

Cable

- 1.5 metres from controller to valve

*Not with ECO EU9M/EU10M products. The battery backup is within the ECOTrans transformer.

PIR FLUSHING CONTROLS FOR URINAL CISTERNS ECO EU9 AND EU10

Installation Notes

Electronics

ECO EU9 and EU10 Controllers are ceiling mounted approximately 1 metre back from the urinal wall and above the main foot traffic to the urinals. EU9 surface units can also be fitted to vertical walls, adjacent to the cistern, at a height of approximately 2 metres.

ECO EU10 sensors fit flush with the ceiling and the controller is installed behind the ceiling tile/panel. Installation requires cutting a 22mm round hole and two screw holes to secure sensor and controller together.

Controllers should not be installed above heat sources (i.e. radiators) and the PIR slots should be sited away from direct sunlight.

Plumbing

The valve is installed on the 15mm mains or pressurised water pipe to the flush cistern. The distance guidance given on the drawings should be noted. The valve should have accessible isolation fittings for servicing and ideally strainer protection. A combined Isolation Valve with Strainer is available from ECO-Logic UK.

NB. When installed with direct fed mains cold water, a check valve should be installed before the Solenoid Valve.

INSTALLATION SCHEMATIC ECO EU10

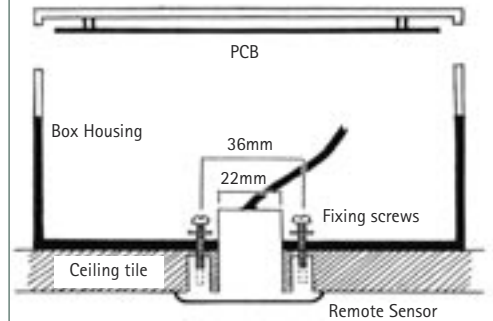

Note:

Sensor can be separately mounted from control box. Notify at time of order.

Technical Information

Control Box Material	ABS Plastic (white)
Sensor Type	Passive Infra Red (PIR)
Operating Voltage	6vDC (Battery or Mains-Reduced)
Battery Type	Lithium Cell 1.3 AH
Mains Power Transformer	ECO 230v/6vDC Transformer with battery backup
Range Detection	4 metres / 35 degree angle (maximum)
Flush Intervals	Adjustable to 75 minutes
Cistern Fill Time	Adjustable to 264 minutes
Valve Connections	15mm Compression
Valve Type	Solenoid coil magnetic latching
Mode of Operation	Normally fail closed
Operating Pressure	Standard. ECO 02 Valve 0-12 bar Low. ECO 04 Valve 0-2 bar
Flow Rate	0-8.5 pm. Pressure Dependent
Cable type	2 Core 0.5mm ² to BS21824
Water Regulation	Schedule 2, Section 9, Para 25.10a

All systems and valves have WRAS approvals.

Related Product Sheets

Urinal Flushing	Direct Acting Flushing	U23
	ECO Trans Sense EU13CT	U14
Secure Sanitaryware	Polymer Range	POL16
	Stainless Steel Range	ELC17
Transformer	ECOTrans Transformer	TR15
Other Fittings	15mm Isolation Valve with Strainer	

ECO-Logic provide solutions for:-

Handwashing • Bathfills • Showering • Flushing • Kitchens

Multi-Channel & Modular Controls for Ensuite Bathrooms & Washrooms

Secure sanitaryware • Lockout Systems • Shutdown Controls • BMS Links

Download at www.ecologicuk.com

Warranties

ECO-Logic Controllers and Sensor Electronics 2 years

ECO-Logic Solenoid Valves (Strainer Protected) 2 years

Brassware and other fittings 1 year

All ECO electronic products are designed, tested and manufactured in the UK to CE standards.

Maintenance

- Replacement parts, batteries and service kits are available direct from ECO-Logic UK.
- Allow for access to Sensors, Solenoid Valves & ECO Controllers.
- Maintenance requirements are very low. All product warranties are dependent on fittings being installed in accordance with ECO-Logic instructions.
- Battery life usually between 3 – 5 years (not Infra Red). Battery in ECOTrans transformers should last up to 10 years, depending on usage.
- All ECO-Logic Controllers have a non-volatile memory which retain setup programmes if power is lost/switched off for maintenance.
- Solenoid Valves should be installed with service valves and strainers to allow inspection and cleaning.
- Spares advice on individual products are provided in maintenance manuals.